

NOTICE!!

These documents have been scanned!

Do not place un-scanned documents beneath this notice!

Do not remove this notice from this file!

GPO Jacket No. 560-102
Print Order 61540
Rise Business Services, LLC
Job=AZ15 5/13/2019



Box Number= AZ15043



Claim Begin-End: AMC418635-AMC418636

1 Initial Receipt



AZ15043-5

AMC418628-AMC420131

United States Department of the Interior
Bureau of Land Management
 LANDS/RECREATION & PLANNING
 ONE N CENTRAL AVE
 PHOENIX, AZ 85004 -2203
 Phone: 602-417-9200

Receipt

No: 2784135

Transaction #: 2868682	
Date of Transaction: 05/01/2013	
CUSTOMER:	
	LARRY SELBERG PO BOX 7434 CHANDLER, AZ 85246-7434 US

LINE #	QTY	DESCRIPTION	REMARKS	UNIT PRICE	TOTAL
1	1.00	LOCATABLE MINERALS / MINING CLAIMS- NOT NEW-UNADJUD, ONE AUTH NO. ONLY / MINING CLAIM MONEY RECEIVED CASES: AMC418635/\$420.00	MAINT 2014/3	- n/a -	420.00
TOTAL:					\$420.00

PAYMENT INFORMATION			
1	AMOUNT:	420.00	POSTMARKED: N/A
	TYPE:	CHECK	RECEIVED: 05/01/2013
	CHECK NO:	9208	
	NAME:	SELBERG, LARRY PO BOX 7434 CHANDLER AZ 85246-7434 US	

REMARKS

This receipt was generated by the automated BLM Collections and Billing System and is a paper representation of a portion of the official electronic record contained therein.

United States Department of the Interior
 Bureau of Land Management
 LANDS/RECREATION & PLANNING
 ONE N CENTRAL AVE
 PHOENIX, AZ 85004 -2203
 Phone: 602-417-9200

Receipt

No: 2683838

Transaction #: 2765344		ENTERED INTO COMPUTER
Date of Transaction: 11/02/2012		
CUSTOMER:		DEC 18 2012 <i>ps</i>
LARRY SELBERG PO BOX 7434 CHANDLER, AZ 85246-7434 US		

LINE #	QTY	DESCRIPTION	REMARKS	UNIT PRICE	TOTAL
1	2.00	LOCATABLE MINERALS / MINING CLAIMS- NEW, UNADJUD, ONE OR MORE AUTH NOS / NEW MINING CLAIM PROCESSING FEE \$15 CASES: AMC418635/\$15.00, AMC418636/\$15.00		- n/a -	30.00
2	2.00	LOCATABLE MINERALS / MINING CLAIMS- NEW, UNADJUD, ONE OR MORE AUTH NOS / NEW MINING CLAIM LOCATION FEE \$34 CASES: AMC418635/\$34.00, AMC418636/\$34.00		- n/a -	68.00
3	2.00	LOCATABLE MINERALS / MINING CLAIMS- NEW, UNADJUD, ONE OR MORE AUTH NOS / NEW MINING CLAIM MAINT FEE \$140 CASES: AMC418635/\$140.00, AMC418636/\$140.00		- n/a -	280.00
TOTAL:					\$378.00

PAYMENT INFORMATION			
1	AMOUNT:	378.00	POSTMARKED: N/A
	TYPE:	CHECK	RECEIVED: 11/02/2012
	CHECK NO:	9154	
	NAME:	SELBERG, LARRY PO BOX 7434 CHANDLER AZ 85246-7434 US	

REMARKS

This receipt was generated by the automated BLM Collections and Billing System and is a paper representation of a portion of the official electronic record contained therein.

NOTICE!!

These documents have been scanned!

Do not place un-scanned documents beneath this notice!

Do not remove this notice from this file!

GPO Jacket No. 560-102
Print Order 61540
Rise Business Services, LLC
Job=AZ15 5/13/2019



Box Number= AZ15043



Claim Begin-End: AMC418635-AMC418636

2 Correspondence



AZ15043-5

AMC418628-AMC420131

United States Department of the Interior
Bureau of Land Management
Arizona State Office
One North Central Ave., Suite 800
Phoenix, Arizona 85504-4427

December 15, 2013

Attn: Mr. Tony Smith

RE: Mining Claim
3800 (9310) TS
AMC 418636 – WISHBONE mining claim/Stock Raising Homestead Act ref.

Dear Mr. Smith

I am writing in regards to our recent phone conversation concerning your office's certified letter declaring the above cited mining claim as being declared null and void. In your letter (copy attached) you advised that my claim is located on Patented Stock raising Homestead Land. As we discussed I have not mined nor prospected on this claim. As I discussed with you, I have interest in five other mining claims and I and my wife have spent our time recreational mining on a couple of these other claims. As a result we have not disturbed any areas contained on the "Wishbone" claim in question.

Since our conversation on December 11, 2013, I have removed all corner markers/monuments from this claim. It was unfortunate that I could not have been informed of the status of this land at the time of my filing, in which case, this all could have been avoided. In our phone conversation you informed me that a refund of the maintenance fees paid was appropriate. In that regard, on November 2, 2012, I paid by personal check \$140 maintenance fee for 2013; and on May 1, 2013 I paid another \$140 maintenance fee for 2014 paid by personal check as well. Therefore, as discussed please issue a refund in the amount of \$280 for reimbursement of Maintenance fees on the above cited "Wishbone" claim. Please be so kind to issue the refund to my PO Box 7434, Chandler, AZ 85246-7434 address as US mail cannot be received at my residence address.

Very truly yours,

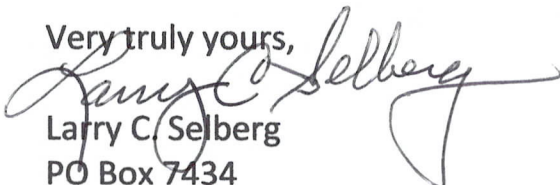

Larry C. Selberg
PO Box 7434
Chandler, AZ. 85246-7434
Cell (480) 789-2863

\$174.00

RECEIVED
BLM AZ STATE OFFICE
2013 DEC 17 P 2:47
PHOENIX, ARIZONA



United States Department of the Interior



BUREAU OF LAND MANAGEMENT
Arizona State Office
One North Central Avenue, Suite 800
Phoenix, Arizona 85004-4427
www.blm.gov/az/

December 4, 2013

In Reply Refer To:
3800 (9310) TS
AMC418635

CERTIFIED MAIL - RETURN RECEIPT REQUESTED No. 7013 0600 0001 7594 3628

DECISION

LARRY SELBERG

P.O. BOX 7434

CHANDLER, AZ. 85246-7434

:
:

This Decision Affects Those Claims
Shown in the Block Below.

AMC418636
WISHBONE

RECEIVED
BLM AZ STATE OFFICE
2013 DEC 17 P 2:41
PHOENIX, ARIZONA

Mining Claim(s) Declared Null and Void Ab Initio

Pursuant to Title 43 Code of Federal Regulations (CFR) 3832.1, this office received your notice(s) of location for recording mining claims. In accordance with 43 CFR 3833.91, the claim(s) listed above is/are hereby declared null and void ab initio for the reason indicated below. A copy of the Master Title Plat is enclosed for your convenience, if applicable.

The placer claim Wishbone, (AMC418636) is located on land that was patented under the Stock Raising Homestead Act of December 29, 1916, (43 U.S.C. 299), patent #1079416. Prior to locating mining claim on this land you must comply with Public Law 103-23; 107 Stat. 60, effective October 13, 1993, and the 43 CFR Part 3838. Therefore, AMC418636 is declared null and void ab initio and is closed.

This decision does not relieve you of the liability for reclamation of all areas disturbed by your activities on land encompassed by your mining claim(s) and/or site(s). After you complete the reclamation, you must notify the authorized officer of the appropriate surface managing agency so that the authorized officer may conduct a final site inspection and determine whether you may be released from liability. If you fail to reclaim the land to the satisfaction of the authorized officer, the surface management agency may cite you for noncompliance under its surface management regulations.

For land administered by the Bureau of Land Management (BLM), if you fail to reclaim the land to the satisfaction of the authorized officer as required in 43 CFR Subpart 3809, the BLM will issue an order of noncompliance under 43 CFR 3809.601(a). If you fail to comply with the

noncompliance order, the BLM may take further action under 43 CFR 3809.604. Failure to conduct reclamation is a prohibited act that may subject you to criminal penalties. See 43 CFR 3809.605(h) and 43 CFR 3809.700. If your occupancy has been terminated and you fail to remove structures, material, and equipment, and any personal property in accordance with the regulations in 43 CFR 3715.5-1, the BLM may dispose of the property. In accordance with 43 CFR 3715.5-2, you will remain liable for the costs the BLM incurs in removing and disposing of the property.

Appeal Procedures

This decision may be appealed to the Interior Board of Land Appeals, Office of the Secretary, in accordance with the regulations contained in 43 CFR, Part 4 and the enclosed Form 1842-1. If an appeal is taken, your notice of appeal must be filed in this office (at the above address) within 30 days from receipt of this decision. The appellant has the burden of showing that the decision appealed from is in error.

If you wish to file a petition pursuant to regulation 43 CFR 4.21 (58 FR 4939, January 19, 1993), for a stay of the effectiveness of this decision during the time that your appeal is being reviewed by the Board, the petition for a stay must accompany your notice of appeal. A petition for a stay is required to show sufficient justification based on the standards listed below. Copies of the notice of appeal and petition for a stay must also be submitted to each party named in this decision and to the Interior Board of Land Appeals and to the appropriate Office of the Solicitor (see 43 CFR 4.413) at the same time the original documents are filed with this office. If you request a stay, you have the burden of proof to demonstrate that a stay should be granted.

Standards for Obtaining a Stay

Except as otherwise provided by law or other pertinent regulation, a petition for a stay of a decision pending appeal shall show sufficient justification based on the following standards:

- (1) The relative harm to the parties if the stay is granted or denied,
- (2) The likelihood of the appellant's success on the merits,
- (3) The likelihood of immediate and irreparable harm if the stay is not granted, and
- (4) Whether the public interest favors granting the stay.

If additional information is required, please contact Tony Smith at 602-417-9355. Please include your AMC serial number(s) on all correspondence.

Rebecca Heick
 Rebecca Heick
 Group Administrator
 Lands and Minerals

RECEIVED
 BLM AZ STATE OFFICE
 2013 DEC 17 P 2:48
 PHOENIX, ARIZONA

Enclosures

11/25/2013
15
A-TCMover
11/25/13
JK
11/26/13

December 4, 2013

In Reply Refer To:
3800 (9310) TS
AMC418635

CERTIFIED MAIL - RETURN RECEIPT REQUESTED No. 7013 0600 0001 7594 3628

DECISION

LARRY SELBERG

P.O. BOX 7434

CHANDLER, AZ. 85246-7434

: This Decision Affects Those Claims
: Shown in the Block Below.

AMC418636
WISHBONE

Mining Claim(s) Declared Null and Void Ab Initio

Pursuant to Title 43 Code of Federal Regulations (CFR) 3832.1, this office received your notice(s) of location for recording mining claims. In accordance with 43 CFR 3833.91, the claim(s) listed above is/are hereby declared null and void ab initio for the reason indicated below. A copy of the Master Title Plat is enclosed for your convenience, if applicable.

The placer claim Wishbone, (AMC418636) is located on land that was patented under the Stock Raising Homestead Act of December 29, 1916, (43 U.S.C. 299), patent #1079416. Prior to locating mining claim on this land you must comply with Public Law 103-23; 107 Stat. 60, effective October 13, 1993, and the 43 CFR Part 3838. Therefore, AMC418636 is declared null and void ab initio and is closed.

This decision does not relieve you of the liability for reclamation of all areas disturbed by your activities on land encompassed by your mining claim(s) and/or site(s). After you complete the reclamation, you must notify the authorized officer of the appropriate surface managing agency so that the authorized officer may conduct a final site inspection and determine whether you may be released from liability. If you fail to reclaim the land to the satisfaction of the authorized officer, the surface management agency may cite you for noncompliance under its surface management regulations.

For land administered by the Bureau of Land Management (BLM), if you fail to reclaim the land to the satisfaction of the authorized officer as required in 43 CFR Subpart 3809, the BLM will issue an order of noncompliance under 43 CFR 3809.601(a). If you fail to comply with the

Refund # 174. Receipt # 2683838
140. Receipt # 2704135

ENTERED
DEC 04 2013
BY: TS

UNITED STATES POSTAL SERVICE

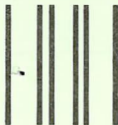

First-Class Mail
Postage & Fees Paid
USPS
Permit No. G-10

- Sender: Please print your name, address, and ZIP+4 in this box •

U.S. Department of the Interior
Bureau Of Land Management
Arizona State Office
One North Central Avenue
Phoenix, AZ 85004-4427



SENDER: COMPLETE THIS SECTION

- Complete items 1, 2, and 3. Also complete item 4 if Restricted Delivery is desired.
- Print your name and address on the reverse so that we can return the card to you.
- Attach this card to the back of the mailpiece, or on the front if space permits.

1. Article Addressed to:

2013 DEC 11 P 2:57

LARRY SELBERG
 P.O. BOX 7434
 CHANDLER, AZ. 85246-7434

9310/TS/AMC418635

2. Article Number

(Transfer from service label)

7013 0600 0001 7594 3628

COMPLETE THIS SECTION ON DELIVERY

A. Signature

X Agent AddresseeB. Received by (*Printed Name*)

C. Date of Delivery

12-10-13

 D. Is delivery address different from item 1? Yes
 If YES, enter delivery address below: No

Larry C. Selberg
 LARRY C. SELBERG

3. Service Type

 Certified Mail Express Mail Registered Return Receipt for Merchandise Insured Mail C.O.D.4. Restricted Delivery? (*Extra Fee*) Yes

noncompliance order, the BLM may take further action under 43 CFR 3809.604. Failure to conduct reclamation is a prohibited act that may subject you to criminal penalties. See 43 CFR 3809.605(h) and 43 CFR 3809.700. If your occupancy has been terminated and you fail to remove structures, material, and equipment, and any personal property in accordance with the regulations in 43 CFR 3715.5-1, the BLM may dispose of the property. In accordance with 43 CFR 3715.5-2, you will remain liable for the costs the BLM incurs in removing and disposing of the property.

Appeal Procedures

This decision may be appealed to the Interior Board of Land Appeals, Office of the Secretary, in accordance with the regulations contained in 43 CFR, Part 4 and the enclosed Form 1842-1. If an appeal is taken, your notice of appeal must be filed in this office (at the above address) within 30 days from receipt of this decision. The appellant has the burden of showing that the decision appealed from is in error.

If you wish to file a petition pursuant to regulation 43 CFR 4.21 (58 FR 4939, January 19, 1993), for a stay of the effectiveness of this decision during the time that your appeal is being reviewed by the Board, the petition for a stay must accompany your notice of appeal. A petition for a stay is required to show sufficient justification based on the standards listed below. Copies of the notice of appeal and petition for a stay must also be submitted to each party named in this decision and to the Interior Board of Land Appeals and to the appropriate Office of the Solicitor (see 43 CFR 4.413) at the same time the original documents are filed with this office. If you request a stay, you have the burden of proof to demonstrate that a stay should be granted.

Standards for Obtaining a Stay

Except as otherwise provided by law or other pertinent regulation, a petition for a stay of a decision pending appeal shall show sufficient justification based on the following standards:

- (1) The relative harm to the parties if the stay is granted or denied,
- (2) The likelihood of the appellant's success on the merits,
- (3) The likelihood of immediate and irreparable harm if the stay is not granted, and
- (4) Whether the public interest favors granting the stay.

If additional information is required, please contact Tony Smith at 602-417-9355. Please include your AMC serial number(s) on all correspondence.

/s/ Rebecca Heick
Rebecca Heick
Group Administrator
Lands and Minerals

Enclosures

NOTICE!!

These documents have been scanned!

Do not place un-scanned documents beneath this notice!

Do not remove this notice from this file!

GPO Jacket No. 560-102
Print Order 61540
Rise Business Services, LLC
Job=AZ15 5/13/2019



Box Number= AZ15043



Claim Begin-End: AMC418635-AMC418636

3 Transfers



AZ15043-5

AMC418628-AMC420131

**NO
DOCUMENTS
FOUND**

NO DOCUMENTS FOUND
NO DOCUMENTS FOUND

NOTICE!!

These documents have been scanned!

Do not place un-scanned documents beneath this notice!

Do not remove this notice from this file!

GPO Jacket No. 560-102
Print Order 61540
Rise Business Services, LLC
Job=AZ15 5/13/2019



Box Number= AZ15043



Claim Begin-End: AMC418635-AMC418636

4 Miscellaneous



AZ15043-5

AMC418628-AMC420131

**NO
DOCUMENTS
FOUND**

NO DOCUMENTS FOUND
NO DOCUMENTS FOUND

NOTICE!!

These documents have been scanned!

Do not place un-scanned documents beneath this notice!

Do not remove this notice from this file!

GPO Jacket No. 560-102
Print Order 61540
Rise Business Services, LLC
Job=AZ15 5/13/2019



Box Number= AZ15043



Claim Begin-End: AMC418635-AMC418636

5 Annual Filings

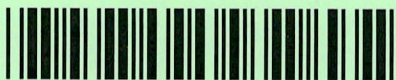

AZ15043-5

AMC418628-AMC420131

AMC 418635

MAINTENANCE FEE PAYMENT

Claimant Name: LARRY SELBERG
Address: P.O. Box 7434
City: CHANDLER State: AZ Zip: 85246
Telephone: (480) 789-2863
E-mail address: L SELBERG@YAHOO.COM
Signature: Larry Selberg

Check here if this is a change of address.

BLM
Date
Stamp

RECEIVED
ARIZONA STATE OFFICE
2019 JUL 18 A 9:31
PHOENIX, ARIZONA

LINE NO.	AMC NUMBER	CLAIM/SITE NAME	COUNTY RECORDER DATA (If available)	TWP	RNG	SEC
1	418635	DREAM CATCHER		9N	5W	25
2						
3						
4						
5						
6						
7						
8						
9						
10						

List additional claims on Form MCF114.

Bureau of Land Management
Arizona State Office
www.blm.gov/az/

No. of Claims*: 1 x \$155 = 165.00
Check No: 0808 Init. 165 PETC
Receipt No.: 4510416
For BLM Use Only

* \$155 per lode mining claim, mill site, or tunnel site; and \$155 for each 20 acres or portion thereof for each placer mining claim.

Form: MCF112
Revised July 2014

ENTERED
JUL 29 2019
BY: [Signature]

This form is available from the Arizona Geological Survey and may be reproduced.

United States Department of the Interior
Bureau of Land Management
 DIV OF LANDS, MINRLS & ENERGY
 ONE N CENTRAL AVE
 PHOENIX, AZ 85004 -4427
 Phone: 602-417-9200

Receipt	
No:	4510416

Transaction #: 4630929
Date of Transaction: 07/18/2019

CUSTOMER:	
LARRY SELBERG PO BOX 7434 CHANDLER, AZ 85246-7434 US	

LINE #	QTY	DESCRIPTION	REMARKS	UNIT PRICE	TOTAL
1	1.00	LOCATABLE MINERALS / MINING CLAIMS- NOT NEW-UNADJUD, ONE AUTH NO. ONLY / MINING CLAIM MONEY RECEIVED CASES: AMC418635/\$165.00	2020 MAINT/1	- n/a -	165.00
TOTAL:					\$165.00

PAYMENT INFORMATION			
1	AMOUNT:	165.00	POSTMARKED: N/A
	TYPE:	CASH	RECEIVED: 07/18/2019
	NAME:	SELBERG, LARRY PO BOX 7434 CHANDLER AZ 85246-7434 US	

REMARKS

This receipt was generated by the automated BLM Collections and Billing System and is a paper representation of a portion of the official electronic record contained therein.

418635

MAINTENANCE FEE PAYMENT

Claimant Name: LARRY SELBERG
Address: P.O. Box 7434
City: CHANDLER State: AZ Zip: 85246
Telephone: (480) 789-2863
E-mail address: L_SELBERG@yahoo.com
Signature: Larry Selberg

RECEIVED
BLM STATE OFFICE
2018 JUN 21 A 10: 06
PHOENIX, ARIZONA
BLM
Date
Stamp

Check here if this is a change of address.

LINE NO.	AMC NUMBER	CLAIM/SITE NAME	COUNTY RECORDER DATA (If available)	TWP	RNG	SEC
1	418635	DREAM CATCHER		9N	5W	25
2						
3						
4						
5						
6						
7						
8						
9						
10						

List additional claims on Form MCF114.

No. of Claims*: 1 x \$155 = 155.00
Check No: _____ Init. _____
Receipt No.: 4194290
For BLM Use Only

Bureau of Land Management
Arizona State Office
www.blm.gov/az/

* \$155 per lode mining claim, mill site, or tunnel site; and \$155 for each 20 acres or portion thereof for each placer mining claim.

Form: MCF112
Revised July 2014

This form is available from the Arizona Geological Survey and may be reproduced.

ENTERED
JUN 22 2018
BY: RAM

United States Department of the Interior
Bureau of Land Management
 DIV OF LANDS, MINRLS & ENERGY
 ONE N CENTRAL AVE
 PHOENIX, AZ 85004 -4427
 Phone: 602-417-9200

Receipt

No: 4194290

Transaction #: 4309058	
Date of Transaction: 06/21/2018	
CUSTOMER:	
LARRY SELBERG PO BOX 7434 CHANDLER, AZ 85246-7434 US	

LINE #	QTY	DESCRIPTION	REMARKS	UNIT PRICE	TOTAL
1	1.00	LOCATABLE MINERALS / MINING CLAIMS- NOT NEW-UNADJUD, ONE AUTH NO. ONLY / MINING CLAIM MONEY RECEIVED CASES: AMC418635/\$155.00	MAINT 2019/1	- n/a -	155.00
TOTAL:					\$155.00

PAYMENT INFORMATION			
1	AMOUNT:	155.00	POSTMARKED: N/A
	TYPE:	CASH	RECEIVED: 06/21/2018
	NAME:	SELBERG, LARRY PO BOX 7434 CHANDLER AZ 85246-7434 US	

REMARKS

This receipt was generated by the automated BLM Collections and Billing System and is a paper representation of a portion of the official electronic record contained therein.

418635

MAINTENANCE FEE PAYMENT

Claimant Name: LARRY SELBERG
 Address: P.O. Box 7434
 City: CHANDLER State: AZ Zip: 85246
 Telephone: (480) 789-2863
 E-mail address: L-SELBERG@YAHOO.COM
 Signature: [Handwritten Signature]
 Check here if this is a change of address.

RECEIVED
 BLM AZ STATE OFFICE
 2017 JUL - 5 A 10: 09
 PHOENIX, ARIZONA
 BLM
 Date
 Stamp

LINE NO.	AMC NUMBER	CLAIM/SITE NAME	COUNTY RECORDER DATA (If available)	TWP	RNG	SEC
1	418635	DREAM CATCHER		9N	5W	25
2						
3						
4						
5						
6						
7						
8						
9						
10						

List additional claims on Form MCF114.

Bureau of Land Management
Arizona State Office
www.blm.gov/az/

No. of Claims*: 1 x \$155 = 155
 Check No: 9601 Init. [Signature]
 Receipt No.: 3879544
 For BLM Use Only

* \$155 per lode mining claim, mill site, or tunnel site; and \$155 for each 20 acres or portion thereof for each placer mining claim.

Form: MCF112
 Revised July 2014

This form is available from the Arizona Geological Survey and may be reproduced.

ENTERED
 JUL 06 2017
 BY: RAM

SUPPLEMENTAL ATTACHMENT

May be used with the following forms for listing additional mining claims:

Check One.

- Affidavit of Performance of Annual Work
- Maintenance Fee Payment
- Notice of Intent to Hold Mining Claims
- Notice of Non-Liability for Labor and Materials Furnished
- Quit claim Deed

BLM Date Stamp

LINE NO.	AMC NUMBER	CLAIM/SITE NAME	COUNTY RECORDER DATA (If available)	TWP	RNG	SEC

Form MCF114
Revised July 2014

This form is available from the **Arizona Geological Survey** and may be reproduced.

United States Department of the Interior
Bureau of Land Management
 DIV OF LANDS, MINRLS & ENERGY
 ONE N CENTRAL AVE
 PHOENIX, AZ 85004 -4427
 Phone: 602-417-9200

Receipt

No: 3879544

Transaction #: 3988635	
Date of Transaction: 07/05/2017	
CUSTOMER:	
LARRY SELBERG PO BOX 7434 CHANDLER, AZ 85246-7434 US	

LINE #	QTY	DESCRIPTION	REMARKS	UNIT PRICE	TOTAL
1	1.00	LOCATABLE MINERALS / MINING CLAIMS- NOT NEW-UNADJUD, ONE AUTH NO. ONLY / MINING CLAIM MONEY RECEIVED CASES: AMC418635/\$155.00	MAINT 2018/1	- n/a -	155.00
TOTAL:					\$155.00

PAYMENT INFORMATION			
1	AMOUNT:	155.00	POSTMARKED: N/A
	TYPE:	CHECK	RECEIVED: 07/05/2017
	CHECK NO:	9601	
	NAME:	SELBERG, LARRY PO BOX 7434 CHANDLER AZ 85246-7434 US	

REMARKS

This receipt was generated by the automated BLM Collections and Billing System and is a paper representation of a portion of the official electronic record contained therein.

418635

MAINTENANCE FEE PAYMENT

Claimant Name: LARRY SELBERG
Address: P.O. Box 7434
City: CHANDLER State: AZ Zip: 85246
Telephone: (480) 789-2863
E-mail address: L-SELBERG@YAHOO.COM
Signature: Larry Selberg

Check here if this is a change of address.

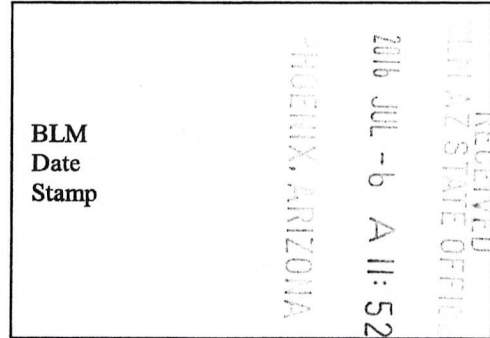

LINE NO.	AMC NUMBER	CLAIM/SITE NAME	COUNTY RECORDER DATA (If available)	TWP	RNG	SEC
1	418635	DREAM CATCHER		9N	5W	25
2						
3						
4						
5						
6						
7						
8						
9						
10						

List additional claims on Form MCF114.

No. of Claims*: 1 x \$155 = 155⁰⁰
 Check No: 9493 Init. PETE
 Receipt No.: 3600051
 For BLM Use Only

Bureau of Land Management
Arizona State Office
www.blm.gov/az/

* \$155 per lode mining claim, mill site, or tunnel site; and \$155 for each 20 acres or portion thereof for each placer mining claim.

Form: MCF112
Revised July 2014

This form is available from the **Arizona Geological Survey** and may be reproduced.

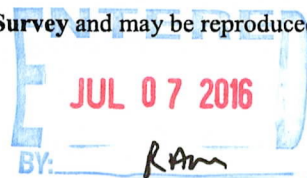

United States Department of the Interior
Bureau of Land Management
 DIV OF LANDS, MINRLS & ENERGY
 ONE N CENTRAL AVE
 PHOENIX, AZ 85004 -4427
 Phone: 602-417-9200

Receipt

No: 3600051

Transaction #: 3703400	
Date of Transaction: 07/06/2016	
CUSTOMER:	
LARRY SELBERG PO BOX 7434 CHANDLER, AZ 85246-7434 US	

LINE #	QTY	DESCRIPTION	REMARKS	UNIT PRICE	TOTAL
1	1.00	LOCATABLE MINERALS / MINING CLAIMS- NOT NEW-UNADJUD, ONE AUTH NO. ONLY / MINING CLAIM MONEY RECEIVED CASES: AMC418635/\$155.00	2017 MAINT/1	- n/a -	155.00
TOTAL:					\$155.00

PAYMENT INFORMATION			
1	AMOUNT:	155.00	POSTMARKED: N/A
	TYPE:	CHECK	RECEIVED: 07/06/2016
	CHECK NO:	9493	
	NAME:	SELBERG, LARRY PO BOX 7434 CHANDLER AZ 85246-7434 US	

REMARKS

This receipt was generated by the automated BLM Collections and Billing System and is a paper representation of a portion of the official electronic record contained therein.

418635

418698

424428

423147

MAINTENANCE FEE PAYMENT

Claimant Name: LARRY SELBERG
 Address: PO Box 7434
 City: CHANDLER State: AZ Zip: 85246
 Telephone: (480) 789-2863
 E-mail address: L-SELBERG@YAHOO.COM
 Signature: Larry Selberg

RECEIVED
 AZ STATE OFFICE
 2015 MAR 26 A 10:33
 PHOENIX, ARIZONA
 BLM
 Date
 Stamp

Check here if this is a change of address.

LINE NO.	AMC NUMBER	CLAIM/SITE NAME	COUNTY RECORDER DATA (If available)	TWP	RNG	SEC
1	418635	DREAM CATCHER		9N	5W	25
2						
3						
4						
5						
6						
7						
8						
9						
10						

List additional claims on Form MCF114.

Bureau of Land Management
Arizona State Office
www.blm.gov/az/

No. of Claims*: 1 x \$155 = 155
 Check No: 9390 Init. ESG
 Receipt No.: 3258 281
 For BLM Use Only

* \$155 per lode mining claim, mill site, or tunnel site; and \$155 for each 20 acres or portion thereof for each placer mining claim.

Form: MCF112
 Revised July 2014

This form is available from the Arizona Geological Survey and may be reproduced.

ENTERED
 MAY 01 2015
 BY: Ram

MAINTENANCE FEE PAYMENT

Claimant Name: LARRY SELBERG
 Address: P.O. Box 7434
 City: CHANDLER State: AZ Zip: 85246
 Telephone: (480) 789-2863
 E-mail address: L-SELBERG@Yahoo.com
 Signature: Larry Selberg

Check here if this is a change of address.

RECEIVED
 AZ STATE OFFICE
 2015 MAR 26 A 10:38
 PHOENIX, ARIZONA
 BLM
 Date
 Stamp

LINE NO.	AMC NUMBER	CLAIM/SITE NAME	COUNTY RECORDER DATA (If available)	TWP	RNG	SEC
1	418698	Billie R		9N	5W	25
2						
3						
4						
5						
6						
7						
8						
9						
10						

List additional claims on Form MCF114.

Bureau of Land Management
Arizona State Office
www.blm.gov/az/

No. of Claims*: 1 x \$155 = 155.00
 Check No: 9391 Init. LSG
 Receipt No.: _____
For BLM Use Only

* \$155 per lode mining claim, mill site, or tunnel site; and \$155 for each 20 acres or portion thereof for each placer mining claim.

Form: MCF112
 Revised July 2014

This form is available from the **Arizona Geological Survey** and may be reproduced.

ENTERED
 MAY 01 2015
 BY: Rdm

MAINTENANCE FEE PAYMENT

Claimant Name: LARRY SELBERG
 Address: P.O. Box 7434
 City: CHANDLER State: AZ Zip: 85246
 Telephone: (480) 789-2863
 E-mail address: L_SELBERG@YHOO.COM
 Signature: [Signature]

RECEIVED
 AZ STATE OFFICE
 2015 MAR 26 A 10: 33
 PHOENIX, ARIZONA
 BLM
 Date
 Stamp

Check here if this is a change of address.

LINE NO.	AMC NUMBER	CLAIM/SITE NAME	COUNTY RECORDER DATA (If available)	TWP	RNG	SEC
1	424428	GOLD GULCH		9N	5W	13
2	423147	HAVALINA #1		9N	5W	13
3	423148	HAVA LINA #2		9N	5W	13
4						
5						
6						
7						
8						
9						
10						

List additional claims on Form MCF114.

Bureau of Land Management
Arizona State Office
www.blm.gov/az/

No. of Claims*: 3 x \$155 = 465.00
 Check No: 9389 Init. [Signature]
 Receipt No.: _____
For BLM Use Only

* \$155 per lode mining claim, mill site, or tunnel site; and \$155 for each 20 acres or portion thereof for each placer mining claim.

Form: MCF112
 Revised July 2014

This form is available from the Arizona Geological Survey and may be reproduced.

INTERESTED

MAY 01 2015

BY: [Signature]

Receipt

United States Department of the Interior
Bureau of Land Management
 LANDS/RECREATION & PLANNING
 ONE N CENTRAL AVE
 PHOENIX, AZ 85004 -2203
 Phone: 602-417-9200

Receipt

No: 3258281

Transaction #: 3353701	
Date of Transaction: 03/26/2015	
CUSTOMER:	
LARRY SELBERG PO BOX 7434 CHANDLER, AZ 85246-7434 US	

LINE #	QTY	DESCRIPTION	REMARKS	UNIT PRICE	TOTAL
1	1.00	LOCATABLE MINERALS / MINING CLAIMS- NOT NEW-UNADJUD, ONE AUTH NO. ONLY / MINING CLAIM MONEY RECEIVED CASES: AMC418635/\$775.00	2016 MAINT (5)	- n/a -	775.00
TOTAL:					\$775.00

PAYMENT INFORMATION					
1	AMOUNT:	465.00	POSTMARKED:	N/A	
	TYPE:	CHECK	RECEIVED:	03/26/2015	
	CHECK NO:	9389			
	NAME:	SELBERG, LARRY			
2	AMOUNT:	155.00	POSTMARKED:	N/A	
	TYPE:	CHECK	RECEIVED:	03/26/2015	
	CHECK NO:	9390			
	NAME:	SELBERG, LARRY			
3	AMOUNT:	155.00	POSTMARKED:	N/A	
	TYPE:	CHECK	RECEIVED:	03/26/2015	
	CHECK NO:	9391			
	NAME:	SELBERG, LARRY			

REMARKS

This receipt was generated by the automated BLM Collections and Billing System and is a paper representation of a portion of the official electronic record contained therein.

ENTERED
MAY 01 2015
BY: *Ram*

418635
418698
424428
423147

MAINTENANCE FEE PAYMENT

Claimant Name: LARRY SELBERG
Address: PO Box 7434
City: CHANDLER State: AZ Zip: 85246
Telephone: (480) 789-2863
E-mail address: L-SELBERG@YAHOO.COM
Signature: Larry Selberg

RECEIVED
BLM
Date
Stamp
2015 MAR 26 A 10:33
PHOENIX, ARIZONA
M AZ STATE OFFICE

Check here if this is a change of address.

LINE NO.	AMC NUMBER	CLAIM/SITE NAME	COUNTY RECORDER DATA (If available)	TWP	RNG	SEC
1	418635	DREAM CATCHER		9N	5W	25
2						
3						
4						
5						
6						
7						
8						
9						
10						

List additional claims on Form MCF114.

No. of Claims*: 1 x \$155 = 155
Check No: 9390 Init. ESG
Receipt No.: 3258 281
For BLM Use Only

Bureau of Land Management
Arizona State Office
www.blm.gov/az/

* \$155 per lode mining claim, mill site, or tunnel site; and \$155 for each 20 acres or portion thereof for each placer mining claim.

Form: MCF112
Revised July 2014

This form is available from the **Arizona Geological Survey** and may be reproduced.

INTERED
MAY - 1 2015
BY: RAM

MAINTENANCE FEE PAYMENT

Claimant Name: LARRY SELBERG
 Address: P.O. Box 7434
 City: CHANDLER State: AZ Zip: 85246
 Telephone: (480) 789-2863
 E-mail address: L-SELBERG@YAHOO.COM
 Signature: Larry Selberg

Check here if this is a change of address.

RECEIVED
 AZ STATE OFFICE
 PHOENIX, ARIZONA
 2015 MAR 26 A 10:33
 BLM
 Date
 Stamp

LINE NO.	AMC NUMBER	CLAIM/SITE NAME	COUNTY RECORDER DATA (If available)	TWP	RNG	SEC
1	418698	Billie R		9N	5W	25
2						
3						
4						
5						
6						
7						
8						
9						
10						

List additional claims on Form MCF114.

Bureau of Land Management
Arizona State Office
www.blm.gov/az/

No. of Claims*: 1 x \$155 = 155.00
 Check No: 9391 Init. SSG
 Receipt No.: 3258281
For BLM Use Only

* \$155 per lode mining claim, mill site, or tunnel site; and \$155 for each 20 acres or portion thereof for each placer mining claim.

Form: MCF112
 Revised July 2014

0002.pdf

MAINTENANCE FEE PAYMENT

Claimant Name: LARRY SELBERG
Address: P.O. Box 7434
City: CHANDLER State: AZ Zip: 85246
Telephone: (480) 789-2863
E-mail address: L-SELBERG@YHoo.com
Signature: [Handwritten Signature]

Check here if this is a change of address.

RECEIVED
AZ STATE OFFICE
2015 MAR 26 A 10:33
PHOENIX, ARIZONA
BLM
Date
Stamp

LINE NO.	AMC NUMBER	CLAIM/SITE NAME	COUNTY RECORDER DATA (If available)	TWP	RNG	SEC
1	424428	GOLD GULCH		9N	5W	13
2	423147	HAVALINA #1		9N	5W	13
3	423148	HAVALINA #2		9N	5W	13
4						
5						
6						
7						
8						
9						
10						

List additional claims on Form MCF114.

Bureau of Land Management
Arizona State Office
www.blm.gov/az/

No. of Claims*: 3 x \$155 = 465.00
Check No: 9389 Init. [Signature]
Receipt No.: 3258281
For BLM Use Only

* \$155 per lode mining claim, mill site, or tunnel site; and \$155 for each 20 acres or portion thereof for each placer mining claim.

Form: MCF112
Revised July 2014

This form is available from the **Arizona Geological Survey** and may be reproduced.

United States Department of the Interior
Bureau of Land Management
 LANDS/RECREATION & PLANNING
 ONE N CENTRAL AVE
 PHOENIX, AZ 85004 -2203
 Phone: 602-417-9200

Receipt

No: 3258281

Transaction #: 3353701	
Date of Transaction: 03/26/2015	
CUSTOMER:	
LARRY SELBERG PO BOX 7434 CHANDLER, AZ 85246-7434 US	

LINE #	QTY	DESCRIPTION	REMARKS	UNIT PRICE	TOTAL
1	1.00	LOCATABLE MINERALS / MINING CLAIMS- NOT NEW-UNADJUD, ONE AUTH NO. ONLY / MINING CLAIM MONEY RECEIVED CASES: AMC418635 /\$775.00	2016 MAINT (5)	- n/a -	775.00
TOTAL:					\$775.00

PAYMENT INFORMATION			
1	AMOUNT:	465.00	POSTMARKED: N/A
	TYPE:	CHECK	RECEIVED: 03/26/2015
	CHECK NO:	9389	
	NAME:	SELBERG, LARRY	
2	AMOUNT:	155.00	POSTMARKED: N/A
	TYPE:	CHECK	RECEIVED: 03/26/2015
	CHECK NO:	9390	
	NAME:	SELBERG, LARRY	
3	AMOUNT:	155.00	POSTMARKED: N/A
	TYPE:	CHECK	RECEIVED: 03/26/2015
	CHECK NO:	9391	
	NAME:	SELBERG, LARRY	

REMARKS

This receipt was generated by the automated BLM Collections and Billing System and is a paper representation of a portion of the official electronic record contained therein.

MAY - 1 2015
 BY: RAM



Brown, Pauline <paulinebrown@blm.gov>

Your request for my maintenance payment forms

2 messages

Fri, May 1, 2015 at 11:39 AM

Larry Selberg <l_selberg@yahoo.com>
Reply-To: Larry Selberg <l_selberg@yahoo.com>
To: "paulinebrown@blm.gov" <paulinebrown@blm.gov>

Pauline Brown

Attached are the Maintenance Fee Payment forms that you called me about (Forms MCF112). One form has three (3) claims cited on it "Gold Gulch" 424428, "Havalina #1" 423147, and "Havalina #2" 423148. The other three forms have one claim cited on each form. "Dream Catcher" 418635 on one form, "Billie R" 418698 on another form, and "Lucky Lady" 418634 on the last form. All were paid on March 26, 2015. PLEASE CALL ME IF YOU CAN NOT ACCESS THESE DOCUMENTS, AND I WILL FAX THEM TO YOU. THANK YOU SO MUCH FOR YOUR HELP, MY CEL PHONE IS (480) 789-2863.

LARRY SELBERG

4 attachments

- IMG_20150501_0002.pdf [3-CLAIMS: AMC 424428, AMC 423147-148] For Receipt # 3258281
557K
- IMG_20150501_0003.pdf [1-CLAIM: AMC 418635] For Receipt # 3258281
532K
- IMG_20150501_0004.pdf [1-CLAIM: AMC 418698] For Receipt # 3258281
528K
- IMG_20150501_0005.pdf [1-CLAIM: AMC 418634] For Receipt # 3258258
547K

Brown, Pauline <paulinebrown@blm.gov>
To: Larry Selberg <l_selberg@yahoo.com>

Fri, May 1, 2015 at 12:00 PM

Thank you Sir,

I will print the attached documents and have the payments processed today.

Regards,

PAULINE BROWN
LAND LAW EXAMINER
BUREAU OF LAND MANAGEMENT
ARIZONA STATE OFFICE
ONE NORTH CENTRAL AVE, STE 800
PHOENIX, AZ 85004-4427
OFFICE: (602) 417-9360
FAX: (602) 417-9490; 602-417-9452
paulinebrown@blm.gov
[Quoted text hidden]

Customer Name Update Screen

System ID:MC

Name: SELBERG LARRY

Lookup

Proprietor #: 2339334

Renumber To:

Category: P - PRIVATE

Address: PO BOX 7434

City: CHANDLER

State: AZ

Zip: 852467434

UNDELIVERABLE

Email: l_selberg@yahoo.com

Phone: 480-789-2863

Save

Save/Override DataFlux

Delete

Renumber

Customer details successfully saved for Customer Id 2339334

AMC 418635

782

MAINTENANCE FEE PAYMENT

Claimant Name: LARRY SELBERG
 Address: P.O. Box 7434
 City: CHANDLER State: AZ Zip: 85246
 Telephone: (480) 789-2863
 E-mail address: L_SELBERG@yahoo.com
 Signature: Larry Selberg
 Check here if this is a change of address.

RECEIVED
 BLM
 Date
 Stamp
 PHOENIX, ARIZONA
 2014 JUL 29 P 1:17
 BLM ARIZONA STATE OFFICE

LINE NO.	AMC NUMBER	CLAIM/SITE NAME	COUNTY RECORDER DATA (If available)	TWP	RNG	SEC
1	418635	DREAM CATCHER	2012-0060935	9N	5W	25
2						
3						
4						
5						
6						
7						
8						
9						
10						

List additional claims on Form MCF114.

Bureau of Land Management
 Arizona State Office
 www.blm.gov/az/

No. of Claims: 1 x \$155 = 155.00
 Check No: 9338 Init. ESG
 Receipt No.: 3087919
 For BLM Use Only

Form: MCF112
 Revised July 2009

This form is available from the Arizona Department of Mines and Mineral Resources and may be reproduced.

ENTERED
 JUL 31 2014
 BY: Cam

United States Department of the Interior
Bureau of Land Management
 LANDS/RECREATION & PLANNING
 ONE N CENTRAL AVE
 PHOENIX, AZ 85004 -2203
 Phone: 602-417-9200



Receipt

No: 3087919

Transaction #: 3179280	
Date of Transaction: 07/29/2014	
CUSTOMER:	
LARRY SELBERG PO BOX 7434 CHANDLER, AZ 85246-7434 US	

LINE #	QTY	DESCRIPTION	REMARKS	UNIT PRICE	TOTAL
1	1.00	LOCATABLE MINERALS / MINING CLAIMS- NOT NEW-UNADJUD, ONE AUTH NO. ONLY / MINING CLAIM MONEY RECEIVED CASES: AMC418635/\$155.00	2015 MAINT (1)	- n/a -	155.00
TOTAL:					\$155.00

PAYMENT INFORMATION			
1	AMOUNT:	155.00	POSTMARKED: N/A
	TYPE:	CHECK	RECEIVED: 07/29/2014
	CHECK NO:	9338	
	NAME:	SELBERG, LARRY PO BOX 7434 CHANDLER AZ 85246-7434 US	

REMARKS

This receipt was generated by the automated BLM Collections and Billing System and is a paper representation of a portion of the official electronic record contained therein.

AMC 418635

418698

MAINTENANCE FEE PAYMENT

Claimant Name: LARRY SELBERG
 Address: P.O. Box 7434
 City: CHANDLER State: AZ Zip: 85246
 Telephone: (480) 789-2863
 E-mail address: L-SELBERG@Yahoo.com
 Signature: Larry C. Selberg
 Check here if this is a change of address.

RECEIVED
 BLM AZ STATE OFFICE
 2013 MAY - 1 A 10: 32
 PHOENIX, ARIZONA
 BLM
 Date
 Stamp

LINE NO.	AMC NUMBER	CLAIM/SITE NAME	COUNTY RECORDER DATA (If available)	TWP	RNG	SEC
1	AMC418635	DREAM CATCHER		90N	50W	25
2	AMC418636	Wishbone		90N	50W	001
3	AMC418698	Billy R		90N	50W	25
4	ENTERED INTO COMPUTER MAY 03 2013 <i>ps</i>					
5						
6						
7						
8						
9						
10						

List additional claims on Form MCF114.

Bureau of Land Management
Arizona State Office
www.blm.gov/az/

No. of Claims: 3 x \$140 = 420.00
 Check No: 9208 Init. MLH
 Receipt No.: 2784135
For BLM Use Only

Form: MCF112
 Revised July 2009

United States Department of the Interior
Bureau of Land Management
 LANDS/RECREATION & PLANNING
 ONE N CENTRAL AVE
 PHOENIX, AZ 85004 -2203
 Phone: 602-417-9200

Receipt

No: 2784135

Transaction #: 2868682		ENTERED INTO COMPUTER
Date of Transaction: 05/01/2013		
CUSTOMER:		MAY 03 2013 <i>JB</i>
LARRY SELBERG PO BOX 7434 CHANDLER, AZ 85246-7434 US		

LINE #	QTY	DESCRIPTION	REMARKS	UNIT PRICE	TOTAL
1	1.00	LOCATABLE MINERALS / MINING CLAIMS- NOT NEW-UNADJUD, ONE AUTH NO. ONLY / MINING CLAIM MONEY RECEIVED CASES: AMC418635/\$420.00	MAINT 2014/3	- n/a -	420.00
TOTAL:					\$420.00

PAYMENT INFORMATION				
1	AMOUNT:	420.00	POSTMARKED:	N/A
	TYPE:	CHECK	RECEIVED:	05/01/2013
	CHECK NO:	9208		
	NAME:	SELBERG, LARRY PO BOX 7434 CHANDLER AZ 85246-7434 US		

REMARKS

This receipt was generated by the automated BLM Collections and Billing System and is a paper representation of a portion of the official electronic record contained therein.

Authorized Date 12/18/2013

AZ BLM REFUND FOR \$174 TO LARRY SELBERG ON
Instructions to Accounts AMC418636 CLOSED TO LOC, RECEIPT #2683838, CONTACT T.
SMITH @ 602-417-9355

Login ID 203

Entry Date 12/18/2013

Total Amount \$174.00

Authorized Date 12/18/2013

AZ BLM REFUND FOR \$174 TO LARRY SELBERG ON
Instructions to Accounts AMC418636 CLOSED TO LOC, RECEIPT #2784135, CONTACT T.
SMITH @ 602-417-9355

Login ID 203

Entry Date 12/18/2013

Total Amount \$140.00

NOTICE!!

These documents have been scanned!

Do not place un-scanned documents beneath this notice!

Do not remove this notice from this file!

GPO Jacket No. 560-102
Print Order 61540
Rise Business Services, LLC
Job=AZ15 5/13/2019



Box Number= AZ15043



Claim Begin-End: AMC418635-AMC418636

6 Location Notices-Amendments and Supporting Documents



AZ15043-5 AMC418628-AMC420131

**DEPARTMENT OF THE INTERIOR
BUREAU OF LAND MANAGEMENT
MINING CLAIMS**

(LIVE) Serial Register Page

Run Date/Time: 12/18/2012 03:29 PM

01 10-21-1976;090STAT0090;43USC1744
 Case Type 384201: PLACER CLAIM
 Claim Name: WISHBONE
 Commodity :
 Case Disposition: ACTIVE
 Required Maintenance Fee: \$140.00

Total Acres
 20.000

Serial Number
 AMC418636
 Lead File Number
 AMC418635

Name & Address	Int Rel
SELBERG LARRY PO BOX 7434 CHANDLER, AZ 85246-7434	CLAIMANT

Mer Twp Rng Sec	Quadrant	District/Field Office	County
14 0090N 0050W 001	SE	HASSAYAMPA FO	YAVAPAI

Act Date	Code	Action	Action Remarks	Receipt Number
10/24/2012	403	LOCATION DATE		
11/02/2012	395	RECORDATION NOTICE RECD	1	2683838
11/02/2012	484	LOCATION YEAR / MAINTENANCE	2013;\$140	2683838
11/02/2012	501	ACCT ADV IN LEAD FILE	AMC418635-AMC418636;	
10/24/2012	404	COUNTY RECORDATION	0;4914;244	

Line Nr Remarks

**DEPARTMENT OF THE INTERIOR
BUREAU OF LAND MANAGEMENT
MINING CLAIMS**

(LIVE) Serial Register Page

Run Date/Time: 12/18/2012 03:27 PM

01 10-21-1976;090STAT0090;43USC1744
 Case Type 384201: PLACER CLAIM
 Claim Name: DREAM CATCHER
 Commodity :
 Case Disposition: ACTIVE
 Required Maintenance Fee: \$140.00

Total Acres
 20.000

Serial Number
 AMC418635
 Lead File Number
 AMC418635

Name & Address	Int Rel
SELBERG LARRY PO BOX 7434 CHANDLER, AZ 85246-7434	CLAIMANT

Mer Twp	Rng	Sec	Quadrant	District/Field Office	County
14	0090N	0050W	025 NW	HASSAYAMPA FO	YAVAPAI

Act Date	Code	Action	Action Remarks	Receipt Number
10/25/2012	403	LOCATION DATE		
11/02/2012	395	RECORDATION NOTICE RECD	1	2683838
11/02/2012	484	LOCATION YEAR / MAINTENANCE	2013;\$140	2683838
11/02/2012	501	ACCT ADV IN LEAD FILE	AMC418635-AMC418636;	
10/25/2012	404	COUNTY RECORDATION	0;4914;691	

Line Nr Remarks

Mining Claim Status Report

DATA ENTERED DEC 18 2012

MTP Checked by JK
GEO Checked by JK/pe DEC 18 2012

LEAD SERIAL NUMBER AMC 418635 thru AMC 418636

# OF CLAIMS & TYPE	CHARGES
# <u> </u> LODE	Location Fee @ \$34 = \$ <u>34</u> <u>68</u>
# <u>2</u> PLACER	Processing Fee @ \$15 = \$ <u>30</u> <u>30</u>
# <u> </u> ASSOCIATION PLACER	Maintenance Fee @ \$140 = \$ <u>140</u> <u>280</u>
# <u> </u> MILL SITE	Overage (+) \$ <u> </u>
# <u> </u> TUNNEL SITE	Shortage (-) \$ <u> </u>
	Other Fees \$ <u> </u>
	TOTAL \$ <u>378</u>

TOTAL CLAIM ACREAGE? 40
OF LOCATORS? 1

DOCUMENTS RECEIVED VIA - Over-the-Counter () Mail ()
TIMELY FILED? Yes () No ()

LEGAL DESCRIPTION - T 9N R 5W SEC 25,1
T R SEC
T R SEC
T R SEC

BLM () FOREST SERVICE () SUBJ TO PL 359: Yes () No ()
WILDERNESS AREA: No () Yes ()

SPLIT ESTATE - N/A () SX () PX () SRHA () OTHER ()
Proper Notice Filed if Located on SHRA Lands? N/A () Yes () No ()

RECONVEYED MINERALS ON BLM LANDS REQUIRE OPENING ORDERS FROM 1944 TO 1993 -
Open to Entry on: N/A ()

COMMENTS/STATUS - VOID () PARTIALLY VOID () PVT MINERALS () WITHDRAWN LANDS ()
OTHER ()

Claimant acknowledges that portions of the following claims(s) site(s) may be void or voidable.
Phx 071832 QCD RECON All Min Sec 25 - Open to location JS
418636 - Closed to location SRH TS Sec. 1, 9N, 5W

Printed Name of Claimant Signature of Claimant

***** FINAL ADJUDICATION *****
DATE 8/15 INITIALS JS

ANC418636

ANC418634

ANC418635

RETURN THESE
DOCUMENTS TO:
LARRY SELBERG
10 KAREN COULTER
P.O. Box 959
Congress, AZ 85332

LOCATION NOTICE FOR PLACER MINING CLAIM

NOTICE IS HEREBY GIVEN that the DREAM CATCHER

_____ placer mining claim has been located by

LARRY SELBERG whose current mailing

address is PO Box 7434

CHANDLER, AZ 85246-7434

RECEIVED
BLM AZ STATE OFFICE
2012 NOV -2 P 12: 04
PHOENIX, AZ
BLM
Date
Stamp

The general course of this claim is RECTANGULAR RESEMBLANCE and it is situated in

YAVAPAI County, Arizona.

This claim is 1320 feet in length and 660 feet in width. This claim runs from the location monument on which this location notice is posted approximately 1320 feet in a NORTHERLY direction to the NORTH end line and 660 feet in a EASTERLY direction to the EAST end line.

This claim is marked by four monuments, one at each corner of the claim.

The location monument on which this notice is posted is situated within Section 25, Township

9 N, Range 5 W, Gila Salt River Base and Meridian, Arizona. This claim encompasses portions of the following legal subdivision(s) if located by legal subdivision or the following quarter section (s),

section (s), Township (s) and Range (s) PORTION OF THE NW 1/4 SEC 25

T9N R5W, Gila Salt River Base and Meridian, Arizona.

The locality of this claim with reference to some natural object or permanent monument and additional information (if any) concerning its locality are as follows: A SECTION OF THE CREEK ON

THIS CLAIM IS CROSSED PERPENDICULARLY BY A JEEP TRAIL
AND THIS INTERSECTION LIES APPROXIMATELY 20 FEET SOUTH OF THE NORTH CLAIM

DATED AND POSTED on the ground this 25TH day of OCTOBER, 2012. Boundary Line

LOCATOR (s) Larry Selberg
LARRY SELBERG

Form MCF102
Revised July 2005

This form is available from the Arizona Department of Mines & Mineral Resources and may be reproduced.

AMC418635

RECEIVED
BLM AZ STATE OFFICE
2012 NOV -2 P 12: 03
PHOENIX, AZ

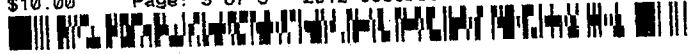

MINING CLAIM MAP

Lode () Placer

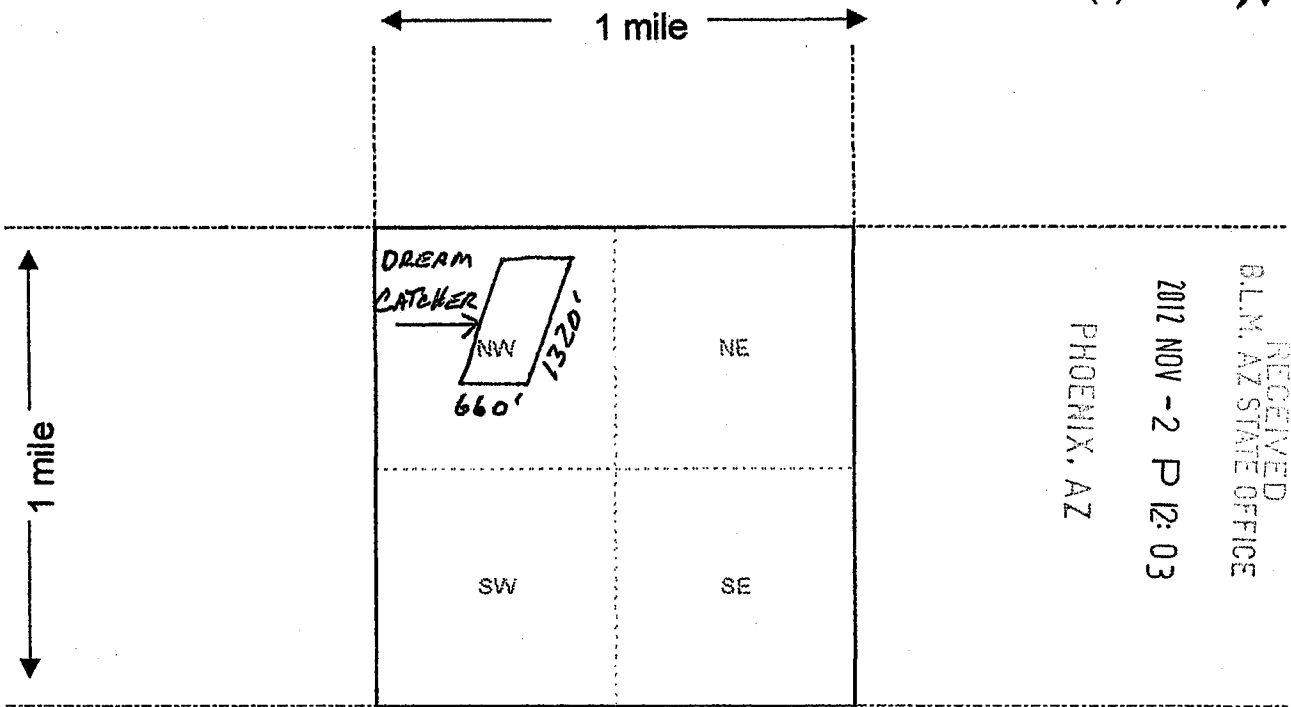

RECEIVED
B.L.M. AZ STATE OFFICE
2012 NOV -2 P 12:03
PHOENIX, AZ

AMC418635

CORNERS ARE NOT 90 DEGREES

Scale: 1" = 2000 feet



- The above map depicts the DREAM CATCHER mining claim, which is located in Section (s) 25, Township 9 N, Range 5 W, Gila and Salt River Base and Meridian, YAVAPAI County, Arizona.
- The type of corner and location monuments used are as follows: 5' TAIL PVC WITH NAME TAG (2" PVC WITH CAP)
- The bearings and distances in degrees and feet between claim corners are as depicted on the map.

A PORTION OF THE NW 1/4 SEC 25 T9N R5W GSR B&M, AZ.

Form MCF100a
Revised July 2005

This form is available from the Arizona Department of Mines & Mineral Resources and may be reproduced.

RECORDERS MEMO: LEGIBILITY
QUESTIONABLE FOR GOOD REPRODUCTION

Arizona Department of Mines & Mineral Resources
1000 North Central Expressway, Suite 1000, Phoenix, Arizona 85004
Phone: (602) 965-2000 Fax: (602) 965-2001
www.azdmsr.com

Arizona Department of Mines & Mineral Resources
1000 North Central Expressway, Suite 1000, Phoenix, Arizona 85004
Phone: (602) 965-2000 Fax: (602) 965-2001
www.azdmsr.com

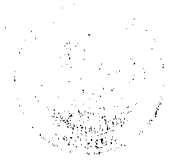



Google earth



DREAM CATCHER CLAIM

NW CORNER

34 05 972 N
112 43 901 W

NE CORNER

34 05 972 N
112 43 769 W

SW CORNER

34 05 773 N
112 44 006 W

SE CORNER

34 05 776 N
112 43 882 W

Larry Selberg

AMC418635

RECORDERS MEMO: LEGIBILITY
QUESTIONABLE FOR GOOD REPRODUCTION

RECEIVED
D.L.M. AZ STATE OFFICE
2012 NOV -2 P 12:03
PHOENIX, AZ

Please Return to
Larry Selberg
P.O. Box 959
Congress, AZ
85332



LOCATION NOTICE FOR PLACER MINING CLAIM

NOTICE IS HEREBY GIVEN that the Wishbone
_____ placer mining claim has been located by
LARRY SELBERG whose current mailing
address is P.O. Box 7434
CHANDLER, AZ 85246-7434

RECEIVED
BLM, AZ STATE OFFICE
2012 NOV - 2 P 12: 04
PHOENIX, AZ
BLM
Date
Stamp

The general course of this claim is A RECTANGLE and it is situated in
YAVAPAI County, Arizona.

This claim is 1320 feet in length and 660 feet in width. This claim runs from the
location monument on which this location notice is posted approximately 1320 feet in a NORTHERLY
direction to the NORTH end line and 660 feet in a EASTERLY direction to the EAST end line.
This claim is marked by four monuments, one at each corner of the claim.

The location monument on which this notice is posted is situated within Section 1, Township
9 N, Range 5 W, Gila Salt River Base and Meridian, Arizona. This claim encompasses
portions of the following legal subdivision(s) if located by legal subdivision or the following quarter section (s),
section (s), Township (s) and Range (s) PORTION OF SE 1/4 SEC 1 T9N R5W
_____, Gila Salt River Base and Meridian, Arizona.

The locality of this claim with reference to some natural object or permanent monument and additional
information (if any) concerning its locality are as follows: LOCATED FROM THE NE
CORNER OF THIS CLAIM IS A HISTORICAL LAND MARK
(ROCK STRUCTURE BUILDING) APPROXIMATELY 790 FEET TO THE NNE.

DATED AND POSTED on the ground this 24TH day of OCTOBER, 2012.

LOCATOR (s) Larry Selberg

Form MCF102
Revised July 2005

This form is available from the Arizona Department of Mines & Mineral Resources and may be reproduced.

AMC 18636

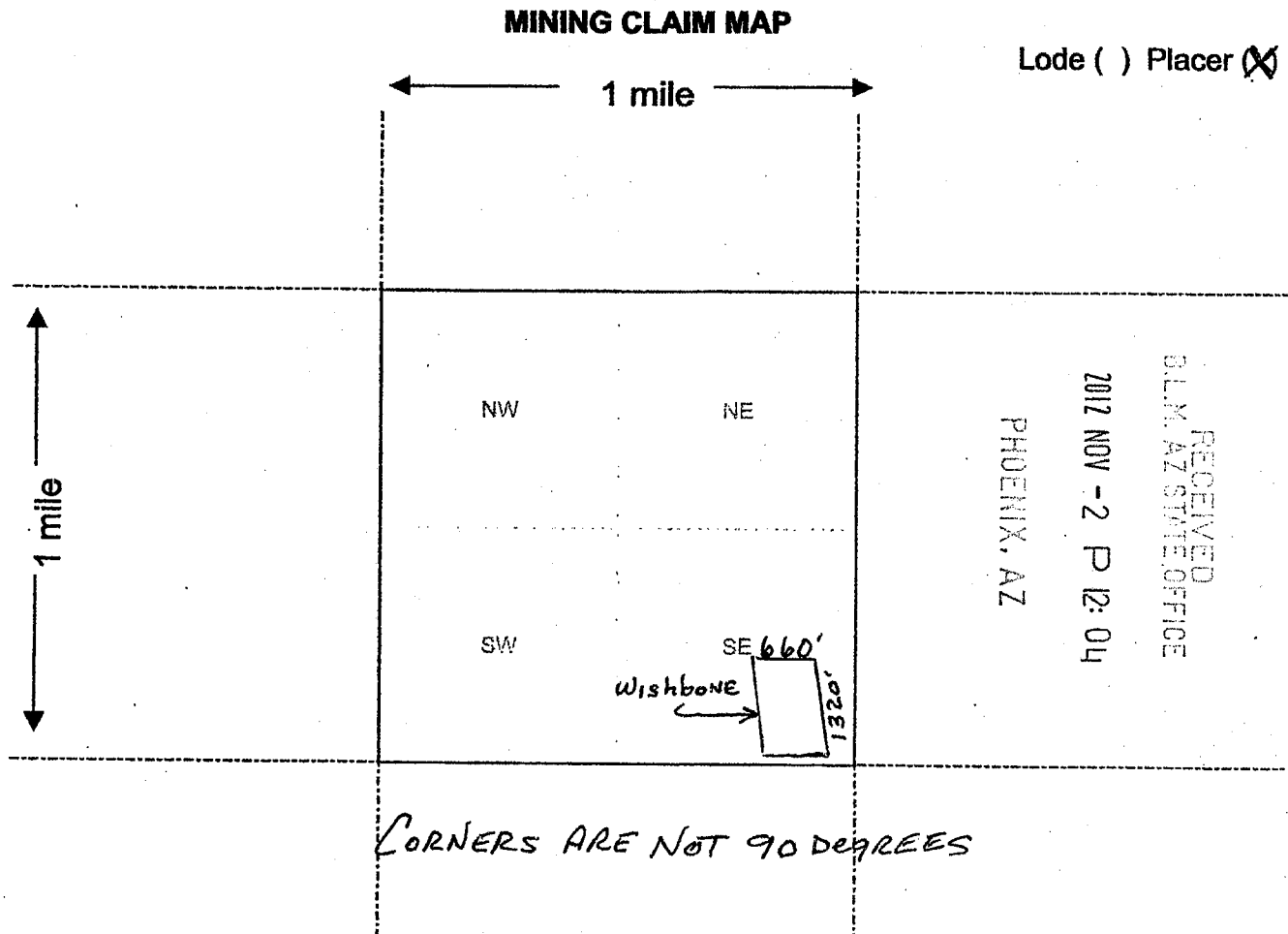

Scale : 1" = 2000 feet



1. The above map depicts the Wishbone mining claim, which is located in Section (s) 1, Township 9 N, Range 5 W, Gila and Salt River Base and Meridian, YAVAPAI County, Arizona.

2. The type of corner and location monuments used are as follows: 5' TAIL PVC WITH NAME TAG (2" PVC WITH CAP)

3. The bearings and distances in degrees and feet between claim corners are as depicted on the map.
A PORTION OF SE 1/4 SE 1/4 SEC 1 T9N R5W GSR B&M, AZ.

Form MCF100a
 Revised July 2005

This form is available from the Arizona Department of Mines & Mineral Resources and may be reproduced.

RECORDERS MEMO: LEGIBILITY
 QUESTIONABLE FOR GOOD REPRODUCTION

A110418636

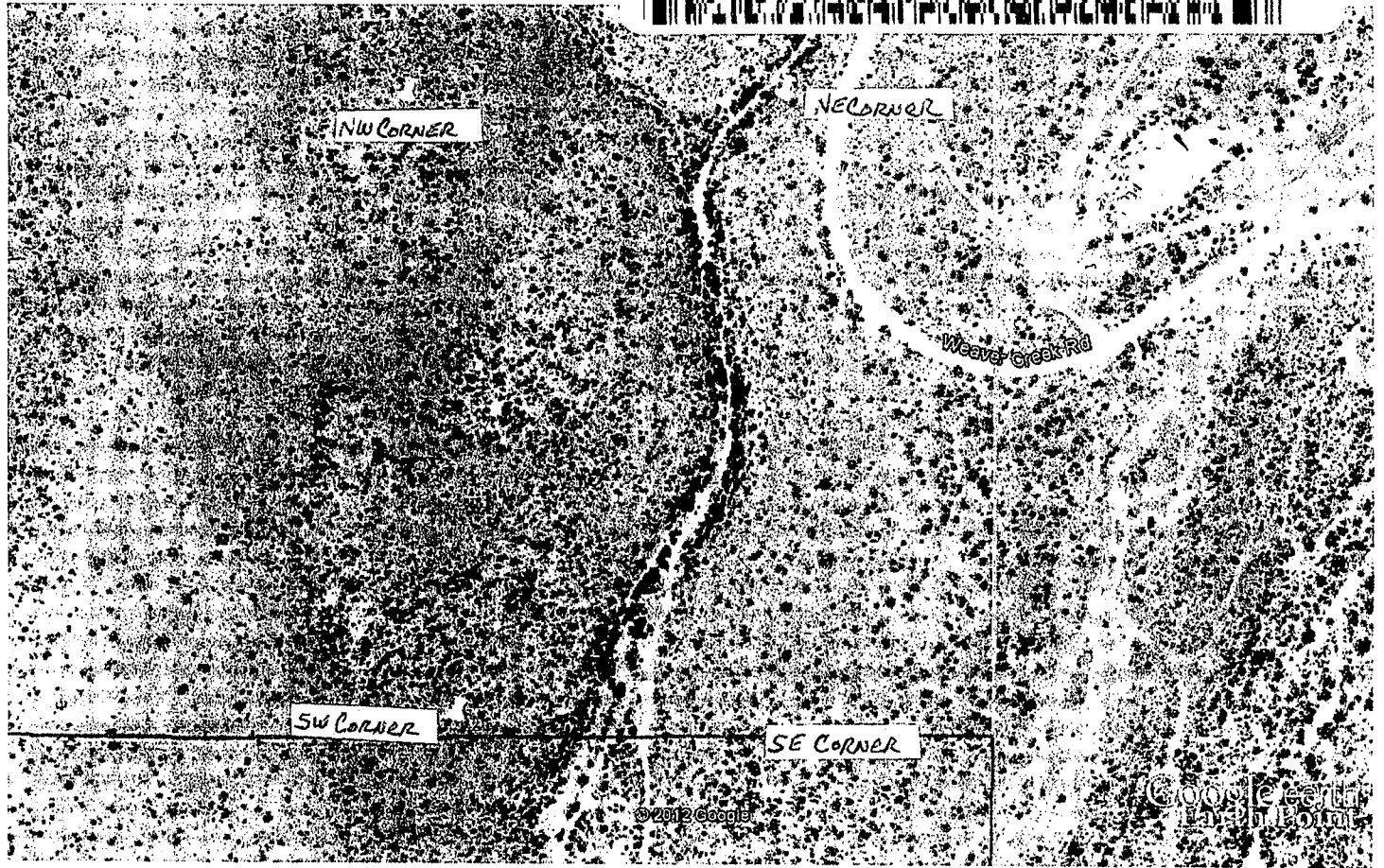

Google earth



Wishbone CLAIM

NW CORNER

34 08 791 N
112 43 349 W

NE CORNER

34 08 794 N
112 43 223 W

SW CORNER

34 08 620 N
112 43 335 W

SE CORNER

34 08 621 N
112 43 208 W

RECORDERS MEMO: LEGIBILITY
QUESTIONABLE FOR GOOD REPRODUCTION

PHOENIX, AZ

2012 NOV - 2 P 12: 04

RECEIVED
BLM, AZ STATE OFFICE

AH0410636

Small, faint, illegible text at the bottom of the page, possibly a recording or filing note.

Small, faint, illegible text at the bottom of the page, possibly a recording or filing note.



Small, faint, illegible text at the bottom of the page, possibly a recording or filing note.

RUN TIME: 03:32 PM

UNITED STATES DEPARTMENT OF INTERIOR
BUREAU OF LAND MANAGEMENT
GEOGRAPHIC REPORT WITH LAND
Sorted by Meridian Township Range

RUN DATE: 12/18/2012

Page 1 of 1

Adm State: AZ

Serial Number: AZA 032278

Total Case Acres: 5.000

<u>Casetype</u>	<u>Case Disp</u>				<u>Sect</u>	<u>Sur Typ</u>	<u>Sur Num</u>	<u>Suff</u>	<u>Subdivision</u>	<u>Act Pend</u>
361112	PENDING	14	0090N	0050W	001	ALL			ENTIRE SECTION	

Serial Number: AZA 035798

Total Case Acres: 5.000

<u>Casetype</u>	<u>Case Disp</u>				<u>Sect</u>	<u>Sur Typ</u>	<u>Sur Num</u>	<u>Suff</u>	<u>Subdivision</u>	<u>Act Pend</u>
380913	AUTHORIZED	14	0090N	0050W	025	ALIQ			NWSW;	

Serial Number: AZAR 0000110

Total Case Acres: 16.660

<u>Casetype</u>	<u>Case Disp</u>				<u>Sect</u>	<u>Sur Typ</u>	<u>Sur Num</u>	<u>Suff</u>	<u>Subdivision</u>	<u>Act Pend</u>
285003	AUTHORIZED	14	0090N	0050W	025	ALIQ			NWNW;	

Serial Number: AZAR 0034626

Total Case Acres: 26.550

<u>Casetype</u>	<u>Case Disp</u>				<u>Sect</u>	<u>Sur Typ</u>	<u>Sur Num</u>	<u>Suff</u>	<u>Subdivision</u>	<u>Act Pend</u>
286202	AUTHORIZED	14	0090N	0050W	025	ALIQ			E2W2;	

13
DEC 18 2012

Input Parameters for Geographic Report with Land

System Id = CR

Admin State = AZ

Geo State = AZ

Casetype Begins With

Case Disp Txt = AUTHORIZED, CANCELLED, EXPIRED, PENDING, REJECTED, RELINQUISHED, WITHDRAWN

Mer Twp Rng =

Section =

Mtrs = 14 0090N 0050W 001, 14 0090N 0050W 025, 14 0090N 0050W 999

Commodity =

Commodity Txt =

Pending Org =

Pend Org Decode =

Total Rows Returned: 4

DEPARTMENT OF INTERIOR
BUREAU OF LAND MANAGEMENT

Input Parameters for Geographic Report with Land

System Id = CR

Admin State = AZ

Geo State =

Casetype Begins With

Case Disp Txt = AUTHORIZED, CANCELLED, EXPIRED, PENDING, REJECTED, RELINQUISHED, VOID, WITHDRAWN

Mer Twp Rng = 14 0090N 0050W

Section = 025, 999

Mtrs =

Commodity =

Commodity Txt =

Pending Org =

Pend Org Decode =

Total Rows Returned: 3

RUN TIME: 11:59 AM

UNITED STATES DEPARTMENT OF INTERIOR
BUREAU OF LAND MANAGEMENT
GEOGRAPHIC REPORT WITH LAND
Sorted by Meridian Township Range

RUN DATE: 11/02/2012
Page 1 of 1

Adm State: AZ

Serial Number: AZA 035798

Total Case Acres: 5.000

<u>Casetype</u>	<u>Case Disp</u>			<u>Sect</u>	<u>Sur Typ</u>	<u>Sur Num</u>	<u>Suff</u>	<u>Subdivision</u>	<u>Act Pend</u>
380913	AUTHORIZED	14	0090N	0050W	025	ALIQ		NWSW;	

Serial Number: AZAR 0000110

Total Case Acres: 16.660

<u>Casetype</u>	<u>Case Disp</u>			<u>Sect</u>	<u>Sur Typ</u>	<u>Sur Num</u>	<u>Suff</u>	<u>Subdivision</u>	<u>Act Pend</u>
285003	AUTHORIZED	14	0090N	0050W	025	ALIQ		NWNW;	

Serial Number: AZAR 0034626

Total Case Acres: 26.550

<u>Casetype</u>	<u>Case Disp</u>			<u>Sect</u>	<u>Sur Typ</u>	<u>Sur Num</u>	<u>Suff</u>	<u>Subdivision</u>	<u>Act Pend</u>
286202	AUTHORIZED	14	0090N	0050W	025	ALIQ		E2W2;	

TOWNSHIP 9 NORTH RANGE 5 WEST OF THE GILA AND SALT RIVER MERIDIAN, ARIZONA

YAVAPAI COUNTY
HASSAYAMPA FIELD OFFICE

STATUS OF PUBLIC DOMAIN
LAND AND MINERAL TITLES



INDEX TO SEGREGATED TRACTS				
TRACT NO	ORIGINAL SURVEY			SUBDIVISION
	T	R	SEC	

FOR ORDERS AFFECTING DISPOSAL OR USE OF UNIDENTIFIED LANDS WITHDRAWN FOR CLASSIFICATION, MINERALS, WATER AND/OR OTHER PUBLIC PURPOSES, REFER TO INDEX OF MISCELLANEOUS DOCUMENTS.

Grazing Dist No 2

AZA 24422 R/W Water Facility 8'
Sec 6: Lots 1, 2, S1/2NE1/4, SE1/4
Sec 7: Lots 1-4, E1/2W1/2

Lat 34°04'16"N
Long 112°43'30"W

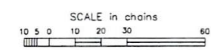

WARNING STATEMENT
This plot is the Bureau's Record of Title, and should be used only as a graphic display of the township survey data. Records herein do not reflect the changes which may have been effected by lateral movements of rivers or other bodies of water. Refer to the cadastral surveys for official survey information.

CURRENT TO	NW	GSR Mer
3-1-2012	ACAD	T 9 N
		R 5 W